

⊕  
ELEVATION 01  
Scale 1:100

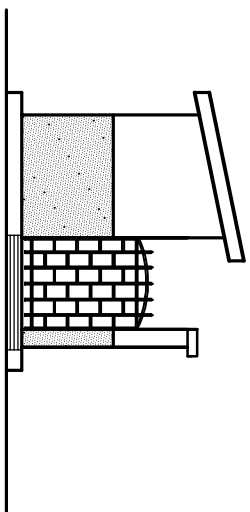

⊕  
ELEVATION 02  
Scale 1:100

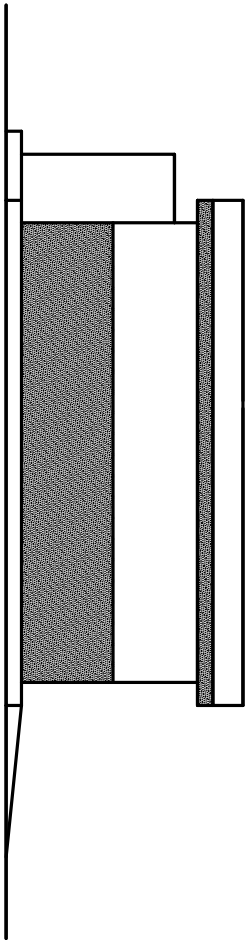

⊕  
ELEVATION 03  
Scale 1:100

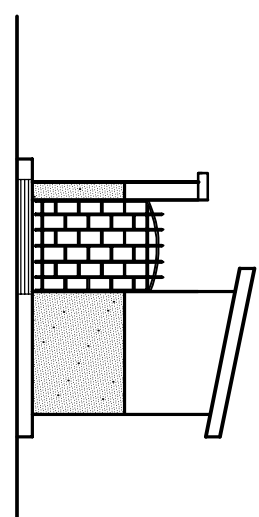

⊕  
ELEVATION 04  
Scale 1:100

- GENERAL NOTES:**
1. All dimensions are to be checked on site when dimensions are followed in preference to coded drawings.
  2. All work shall be done in accordance with the relevant building code of practice.
  3. All sanitary work to be in accordance with MCH 1 rules and regulations.
  4. All work shall be done in accordance with the relevant building code of practice.
  5. All work shall be done in accordance with the relevant building code of practice.
  6. All windows and external glazed doors to be provided with burglar proofing to protect itself.
  7. All door frames to be checked & installed to the University of Kampala.
  8. All fire fighting equipment to be provided as indicated in the Building Fire Control plan when drawn on plan.

ISSUES	
No.	Date:

GREEN HEAT (U) LTD  
P. O Box 102335  
Kampala Uganda

Project: PROPOSED CONSTRUCTION OF  
A 4- STANCES BIOGAS LATRINE BLOCK  
AT SOFT POWER EDUCATION CENTRE  
Client: Soft Power Education Centre  
Jinja District, Uganda.

DRAWING TITLE:	
SECTION	
Date: March, 2011	Scale: 1:100
Drawing No. GHU/02-2011	Drawn: V.T